

Safety Valves DN15



OSU



Safety Valves 1/2 x 1/2" KE

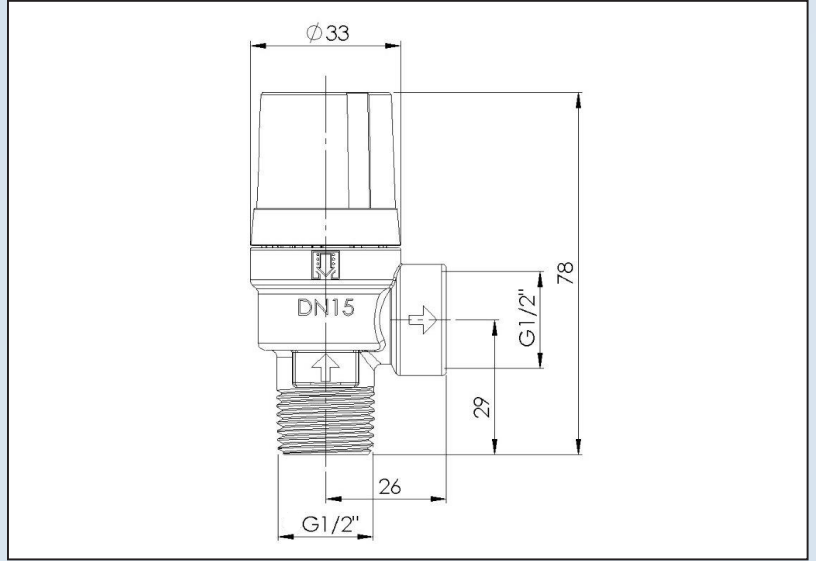
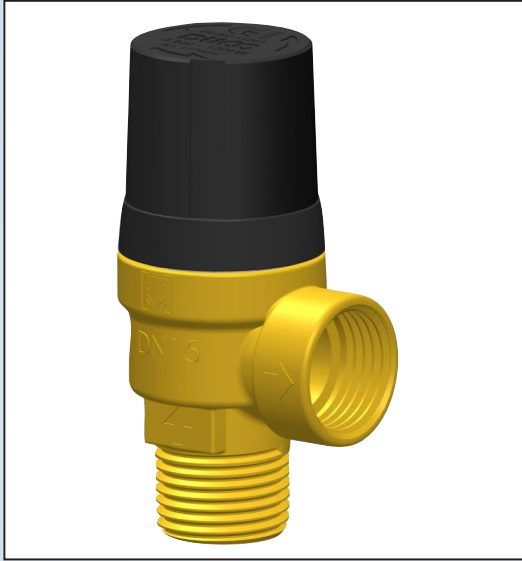

Duco safety valves to protect closed heated and chilled water systems against excessive pressure.

Application

The safety valve has to be used in a closed heating or cooling system (glycol max. 50%) Only use the Duco valve in a dry and frostfree location.
Min / max. system temp.: -10°C / +120°C

Safety

Check whether the max. capacity and the opening pressure that are indicated on the valve match the values of the system.

Code	Set pressure (bar)	Heating capacity (kW)
1015-0-05-11	0,5	48
1015-0-11-11	1	64
1015-0-14-11	2	93
1015-0-15-11	2,5	107
1015-0-16-31	3	120
1015-0-18-11	4	148
1015-0-20-11	5	175
1015-0-26-11	6	200
1015-0-27-11	7	226
1015-0-28-11	8	252
1015-0-29-11	9	278
1015-0-30-11	10	302



All Duco safety valves meet the requirements of the Pressure Equipment Directive (PED) "Directive 2014/68/EU Module B/Module D" The quality system also complies with the NEN-EN-ISO 9001

NORM: NEN-EN-ISO 4126-1

PenTec bv
Edisonweg 7
3442 AC Woerden
The Netherlands

Tel. +31 (0)182 503 100
E-mail info@pentecbv.nl
Internet www.duco.nl
www.pentecbv.nl

